



Teaching Walls



 **MADE IN
BRITAIN**

Specialist Educational Furniture Manufacturer

From our base in Worcestershire (UK) we design, manufacture and install bespoke furniture for schools and educational facilities throughout the UK, Europe and across the globe.

- ▶ Survey & consultation service
- ▶ Drawing & space planning service
- ▶ Bespoke design
- ▶ Extensive range of finishes
- ▶ CNC Technology
- ▶ Installation service & ongoing support
- ▶ Ethically sourced and sustainable timber

Witley Jones Furniture design, manufacture and install high quality bespoke school furniture.

We manufacture to order to meet your requirements, expectations and budget. Be it material type, finish, colours, shapes or dimensions, we help create furniture specific to your requirements.

Our in-house team works closely with you, your contractors and consultants, providing a total service from start to finish, beginning with a free consultation and design service.

Upon agreeing the final design of a project, we work with you to select materials and produce a schedule in conjunction with the overall project plan.

All school furniture is manufactured and assembled in our state of the art factories by experienced skilled staff. We have a dedicated installation team that deliver and fit all pieces of furniture onsite alongside our senior management team, who oversee the completion of every project.

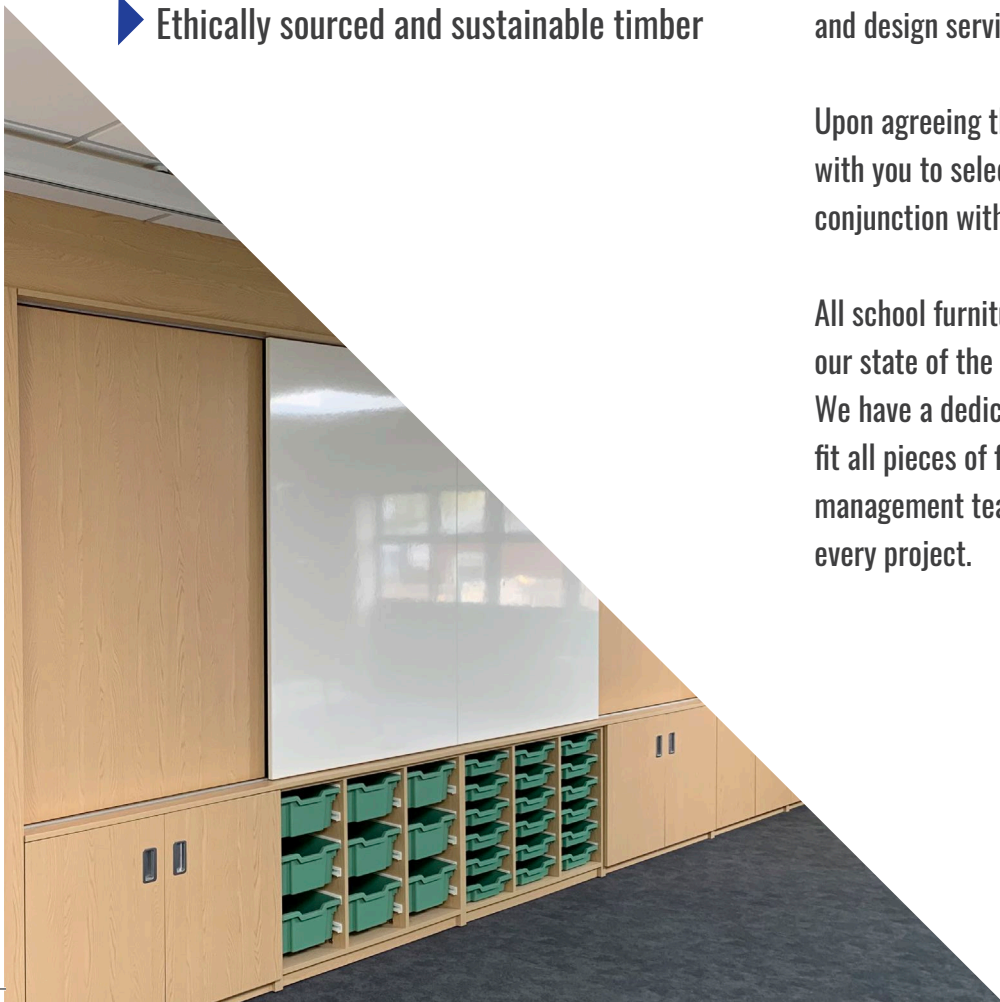

Teaching Walls

A complete storage, IT and teaching solution for your classrooms, teaching walls are suitable for all subject areas including IT suites, science laboratories, food technology rooms and music departments.

We work with you to help maximise the available space and seamlessly integrate a whiteboard and interactive screen, offering additional storage through bookcases, cupboards and drawers to suit a rooms specific dimensions.

We understand that space is at a premium and a storage or teaching wall can be the ideal way to maximise space and reduce encroachment into classrooms and corridors.

What is a Teaching Wall?



Scan QR code





Scan QR code



“ we are very proud of the new facilities
which place us at the cutting edge in
education.... ”
Swanbourne House
Scan the QR code to read full story.



Need Help?

Call one of our
dedicated staff to talk you
through the options
+44 1299 828888

Typical Configurations

Standard Teaching Wall

Standard Teaching Wall
4200(W) x up to 2400(H) x up to 590(D)



Standard Teaching Wall with Teachers Desk



Standard Teaching Wall with Teachers Desk
5250(W) x up to 2400(H) x up to 590(D)

Standard Teaching Wall with Sink Area

Standard Teaching Wall with Sink Area
5250(W) x up to 2400(H) x up to 590(D)

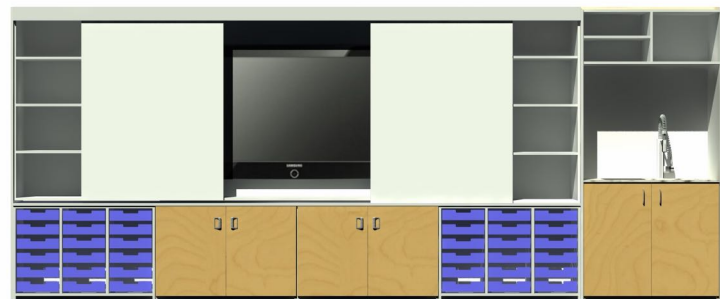

Extended Teaching Wall with Teachers Desk and Top Boxes

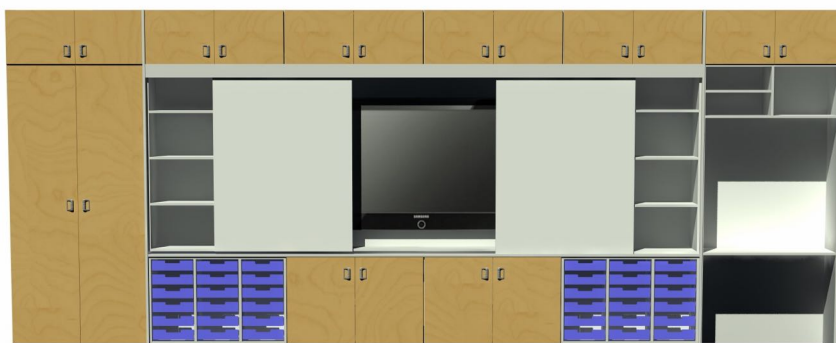

Extended Teaching Wall with Teachers Desk and Top Boxes
Width 6300(W) x up to 2900(H) x up to 590(D)





Scan QR code

Need Help?

Call one of our
dedicated staff to talk you
through the options
+44 1299 828888

“ Witley Jones are proactive in working
around challenges, thereby ensuring
that all furniture is in place by the start
of term. ”
Epsom College
Scan the QR code to read full story.



Components

Base Units

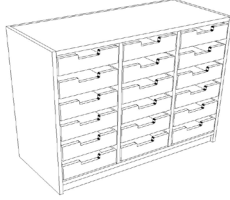

TW101 - Triple Column Tray Unit
1040(W) x up to 730(H) x up to 590(D)

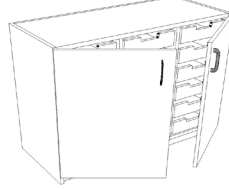

TW102 - Triple Column Tray with Doors
1078(W) x up to 730(H) x up to 590(D)

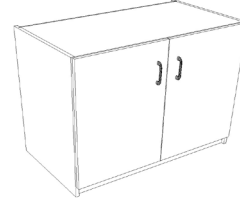

Double Door Base Unit
Width Varies x up to 730mm(H) x up to 590mm (D)
TW103 - 1000mm wide
TW104 - 1040mm wide for use with Tray Unit
TW105 - 1078mm wide for use with Tray Unit with Doors



Double Door Base Unit with Pull Out Desk
Width Varies x 730(H) x up to 590(D)
TW106 - 1000mm wide
TW107 - 1040mm wide for use with Tray Unit
TW108 - 1078mm wide for use with Tray Unit with Doors

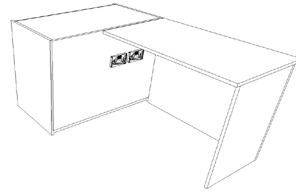

Peninsular Teachers Desk Unit
Width Varies x 730(H) x up to 590(D)
TW109 - 1000mm wide
TW110 - 1040mm wide for use with Tray Unit
TW111 - 1078mm wide for use with Tray Unit with Doors

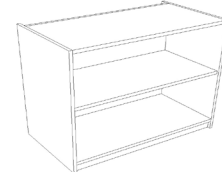

Open Shelf Unit
Width Varies x up to 730(H) x up to 590(D)
TW112 - 1000mm wide
TW113 - 1040mm wide for use with Tray Unit
TW114 - 1078mm wide for use with Tray Unit with Doors

Mid Units

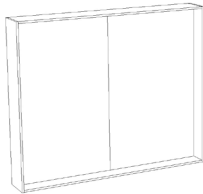

Interactive Whiteboard Housing Unit
Width Varies x up to 1650(H) x 290(D)
TW115 - 2000mm wide
TW116 - 2080mm wide for use with Tray Unit
TW117 - 2156mm wide for use with Tray Unit with Doors



Adjustable Shelving Unit
Width Varies x up to 1650(H) x 390(D)
TW118 - 1000mm wide
TW119 - 1040mm wide for use with Tray Unit
TW120 - 1078mm wide for use with Tray Unit with Doors

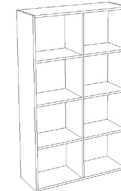

Pigeonhole Mid Unit
Width Varies x up to 1650(H) x 390(D)
TW121 - 1000mm wide
TW122 - 1040mm wide for use with Tray Unit
TW123 - 1078mm wide for use with Tray Unit with Doors

High Units

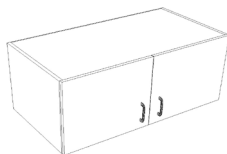

Double Door Top Box
Width Varies x up to 500(H) x up to 590(D)
TW124 - 1000mm wide
TW125 - 1040mm wide for use with Tray Unit
TW126 - 1078mm wide for use with Tray Unit with Doors



Top Hinged Top Box
Width Varies x up to 500(H) x up to 590(D)
TW127 - 1000mm wide
TW128 - 1040mm wide for use with Tray Unit
TW129 - 1078mm wide for use with Tray Unit with Doors



DELIVERY
GUARANTEE



SURVEY
& DESIGN



INSTALLATION
SERVICE

Components

Extra Storage

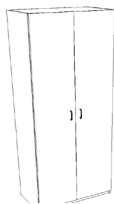

TW130 - Tall Double Door Cupboard
up to 2400(H) x 1000(W) x up to 590(D)



TW131 - Tall Single Door Cupboard
up to 2400(H) x 500(W) x up to 590(D)

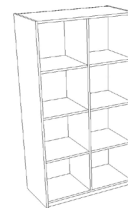

TW132 - Tall Bag Storage Pigeonhole Unit
up to 2400(H) x 1000(W) x up to 590(D)

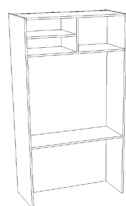

TW133 - Straight Teacher Desk Unit
up to 2400(H) x 1000(W) x up to 590(D)

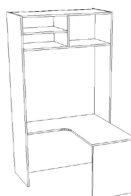

TW134 - L Shape Teacher Desk Unit
up to 2400(H) x 1000(W) x up to 590(D)



TW135 - Sink Unit
up to 2400(H) x 1000(W) x up to 590(D)



TW136 - Tall Display Shelving Unit
up to 2400(H) x 1000(W) x up to 590(D)



Scan QR code



We also offer a large range of Classroom Furniture to complement your teaching wall.

Scan the QR code to find out more.



Scan QR code

5.9.2018

1. Good morning
2. Share all the toys
3. Don't make a mess

School Rules

- We follow everyone's turn of play.
- We wait our turn when it's our turn to play.
- We don't throw or break anything.
- We don't run or climb on furniture.
- We don't use our hands or feet to hurt others.
- We don't use our words to hurt others.



Most importantly we could see how the innovative walls addressed the very challenges we were experiencing at Hollymount....
Hollymount School
Scan the QR code to read full story.



Need Help?

Call one of our dedicated staff to talk you through the options
+44 1299 828888

Materials/Finishes

Standard Melamine Range



51S CALEDONIAN OAK
Sega



9AR HICKORY FRIDA
Boreal



209 MAPLE COLONIA
Atlas



77E JAPANESE ASH
Atlas



41G ROBLE HERA
Sega



49D LISSA OAK
Mesura



910 ROBLE NATURAL
Mesura



366 HAYA RIMESI
Atlas

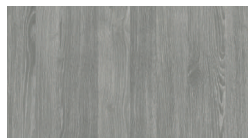

17N ROBLE JOPLIN
Mesura



19N FRESNO ESTEPA
Sega

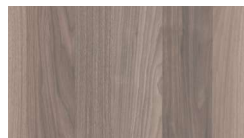

81V NOGAL SIENA
Supermate



75V ROBLE AZABACHE
Atlas

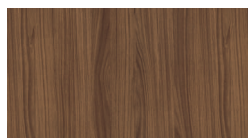

03C NOGAL CANALETTO
Mesura



1AS NOGAL VALENTINA
Mesura



39G FRESNO TEA
Sega

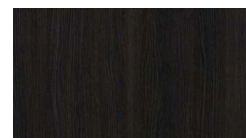

20N ROBLE SINATRA
Atlas

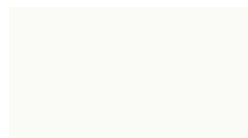

020 BLANCO MEDIO

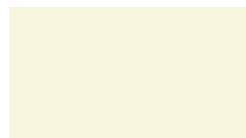

65B IVORY BAMA

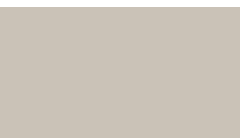

15R GRIS COCO



40Y MINERAL GREY



U12 NATURAL GREY



192 GRIS AZULADO



09F GRIS TORMENTA



71A GRIS GU

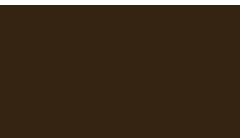

14C TOFFEE



231 NEGRO

Standard Veneer Range



Ash Veneer

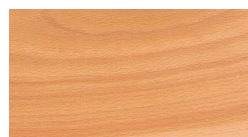

Beech Veneer

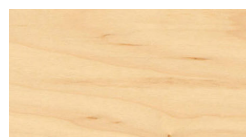

Maple Veneer



Oak Veneer

Further to our standard ranges we are able to offer finishes from all the leading brands of Melamine and Laminate suppliers as well a large range of lacquer and painted finishes from our in house spraying facilities.

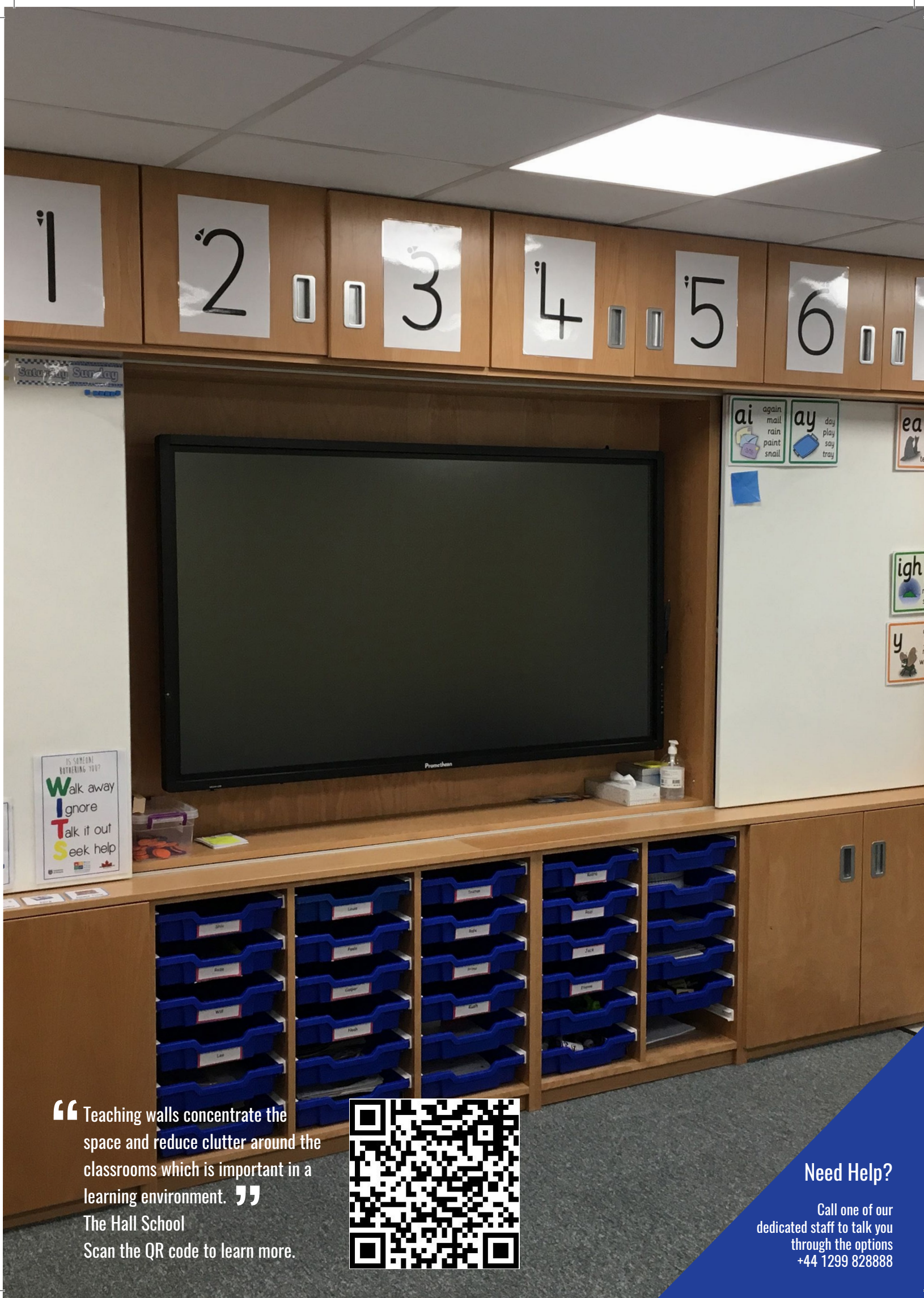

“Teaching walls concentrate the space and reduce clutter around the classrooms which is important in a learning environment.”

The Hall School

Scan the QR code to learn more.





































Need Help?

Call one of our
dedicated staff to talk you
through the options
+44 1299 828888

Specification

Gratnell Tray Options

	F1	F2	F3		F1	F2	F3
Translucent				Midnight Blue			
Sunshine Yellow				Plum Purple			
Jolly Lime				Flame Red			
Grass Green				Tropical Orange			
Cyan Blue				Light Grey			
Royal Blue				Charcoal Grey			
Steel Blue				Jet Black			

Specification

Handles



Wooden Recessed Handle
HAND001 - Ash
HAND002 - Beech
HAND003 - Oak



HAND004
Cutout Handle



HAND005
Metal Recessed Handle



HAND006
Pull Handle



HAND007
Circular Inset Handle



HAND008
Large Bow Handle



HAND009
Large D Handle



HAND010
Small Bow Handle



HAND011
Small D Handle



HAND012
Large T Bar Handle



HAND013
Small T Bar Handle

Hinges



HING002
Heavy Duty Cranked Piano Hinge



HING003
Heavy Duty Piano Hinge



HING004
110 Degree Self Closing Hinge

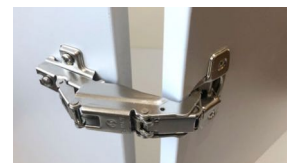

HING005
170 Degree Self Closing Hinge

Drawer Runners



Standard Drawer Runners
RUN001 300mm
RUN002 400mm
RUN003 450mm
RUN004 600mm



Heavy Duty Drawer Runners
RUN005 300mm
RUN006 400mm
RUN007 450mm
RUN008 600mm

Locks



LOCK014A
Lock and Key Set



LOCK021
Single Door Hasp Bar Lock (for padlocks)



LOCK023
Combination Lock



Design Service

Witley Jones Furniture offer a free design service on all teaching wall enquiries.

We can work from your existing CAD plans for the rooms in question or we can visit site to survey the rooms free of charge.

We use two main design software; CAD, which allows us to work in 2D – normally for architect, designer and contractor-led projects and Cabinet Vison, which allows us to create 3D render drawings of your specified furniture options.

We are happy to work alongside your chosen architects, designers and contractors on your teaching wall projects and always encourage our customers to engage with their chosen furniture supplier as early as possible in the design process to ensure your furniture will work with other areas of the build such as window, radiator positions and electrical provision.

Sustainability

Witley Jones Furniture are continually looking at ways of improving the environmental impact of the goods and services we provide and are committed to continually improving our products and services to be as safe and sustainable as possible in the future:

- ▶ Regular product development and continual improvement meetings with key personnel from all areas of our design and manufacturing processes
- ▶ All timber and wood-based products we source are PEFC or FSC certified to ensure they are all ethically and sustainably sourced
- ▶ All of our packaging is recyclable or reusable
- ▶ We use Formaldehyde-free Lacquers
- ▶ Our manufacturing software optimizes board usage to ensure we have as little waste as possible.
- ▶ All of our timber waste and sawdust is used to fuel our biomass boiler system which heats our factory and offices as well as heating the drying rooms in our spray booths
- ▶ We have a programme of replacing our company vehicles to ensure they are running at their most efficient. We have an electric vehicle as part of our fleet and are committed to including more in future



Delivery and Installation

We offer different levels of both delivery and installation to suit your needs and will always be willing to change our offering to ensure we fully meet the needs of your particular project:

Delivery Options

1. Ex works – Furniture will be quoted for the customer to collect from our factory in Worcestershire and for installation by the customer
2. Driver Only Delivery – We will deliver the furniture to your chosen destination with a driver only, the customer will be required to supply labour to offload the vehicle
3. Crewed Delivery – We will deliver the furniture to your chosen destination with a crew of personnel to offload the vehicle and carry the furniture into the respective rooms within the building

Installation Options

1. Client Install – Customer installs their own furniture. Witley Jones can supply fittings and assembly instructions where needed
2. Loose Installation – Our fitting teams will assemble and place the furniture as per the agreed room layouts and remove all packaging from site
3. Fixed Installation – Our fitting teams will assemble and fix furniture in place as per the agreed room layouts and remove all packaging from site
4. Fitted Installation – Our fitting teams will fully fit the furniture including cutting items in to suit the room, i.e cutting worktops into alcoves and scribing furniture around skirting boards and dado rails where needed

Our delivery and fitting teams are all fully insured for the work they are carrying out.

They are also DBS checked and hold CSCS cards. We are also members of CHAS and Constructionline. Please let us know where you require our staff to have DBS and/or CSCS cards so we can ensure the correct personnel are allocated to your project.



Over 400 UK clients

Product Ranges

- ▶ Boarding & Accommodation
- ▶ Classroom Furniture
- ▶ Teaching Walls
- ▶ Science Laboratory
- ▶ Art & Design
- ▶ Lockers & Changing Rooms
- ▶ Dining Furniture
- ▶ Seating & Soft Furnishings
- ▶ ICT
- ▶ Library
- ▶ Bespoke & Special Items

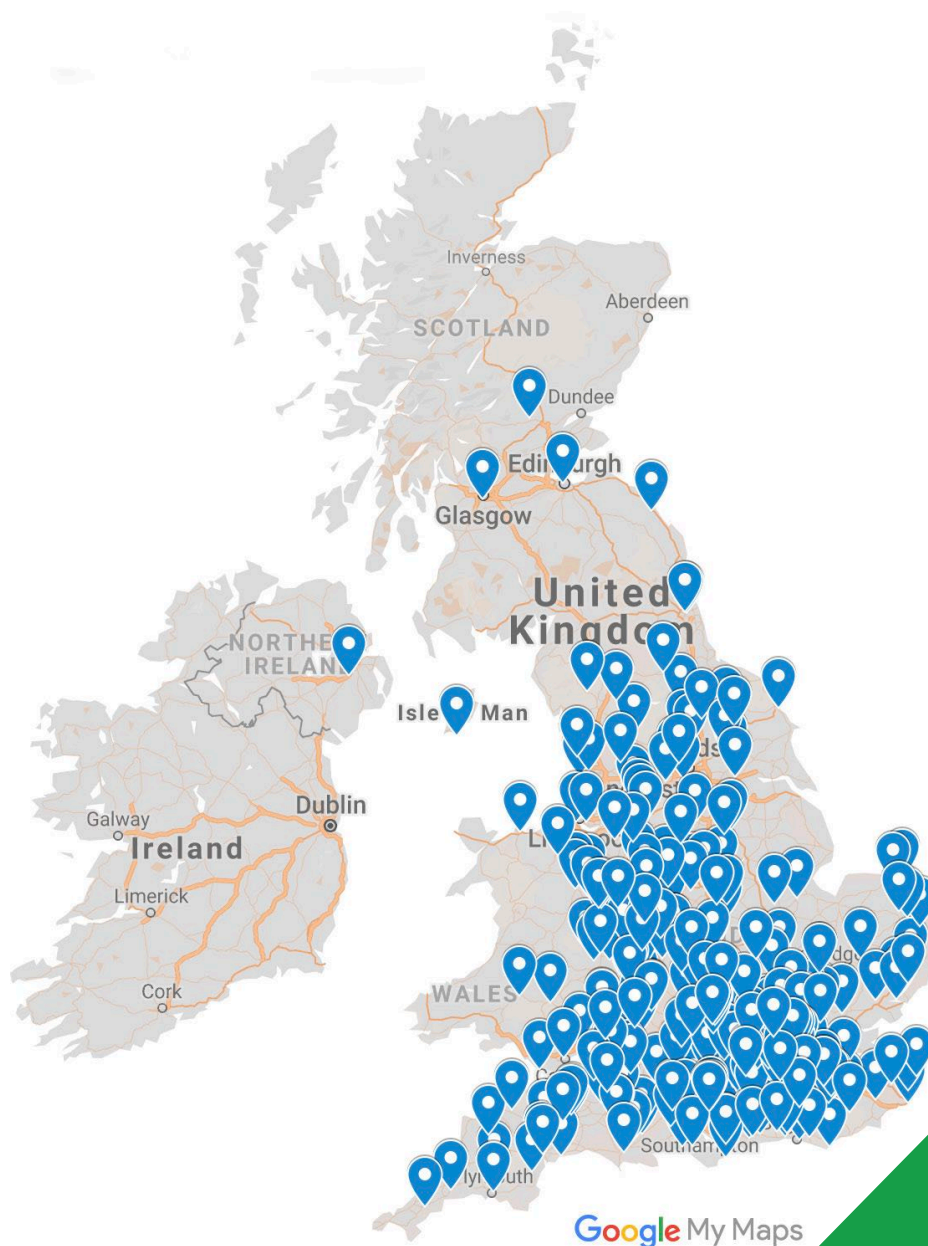

Proud members of:



Call
+44 1299 828888

Visit
www.witleyjones.com

or Email
enquiries@witleyjones.com